

PART NUMBER	REV	A	B	C	D	ØE	ØF	DETAIL		COMMENT
								H	DIM	

REVISIONS			
REV	DESCRIPTION	DATE	APPROVAL
N/C	RELEASED		

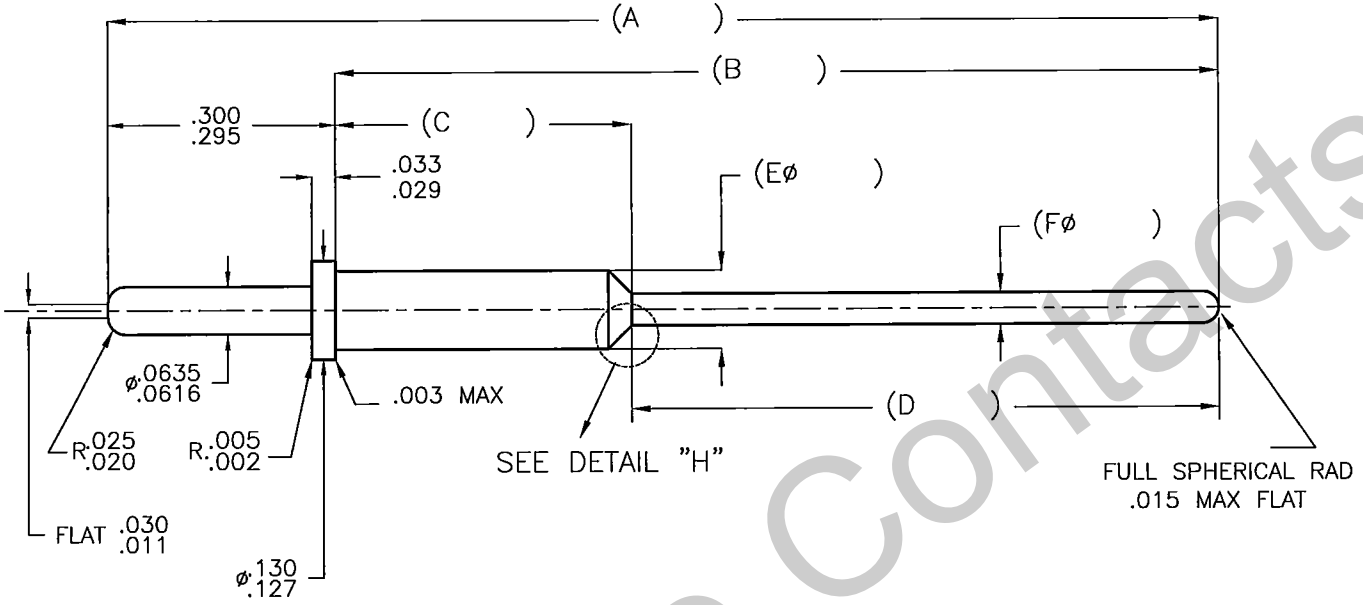

8. CONTACT MEETS OR EXCEEDS SPECIFICATION AND REQUIREMENTS OF MIL-C-39029/58-364, EXCEPT AS INDICATED HEREIN.
 6. CONTACT SHALL MEET THE SOLDERABILITY REQUIREMENTS OF MIL-STD-202, METHOD 208
 5. ALL DIAMETERS ON A COMMON CENTERLINE ARE TO HAVE A CIRCULAR RUNDOUT OF .002 MAX.
 4. DIMENSIONS SHOWN ARE AFTER PLATING.
 3. FINISH: .000050 THICK MINIMUM GOLD PER MIL-G45204, TYPE II, GRADE C, CLASS 1 OVER .000050-.000100 THICK SULFAMATE NICKEL PER QQ-N-290, CLASS 2, OVER .000015 THICK MINIMUM COPPER PER MIL-C-14550.
 2. MATERIAL: A. SUITABLE COPPER ALLOY (LEADED NICKEL COPPER).
 B. BRASS 360 1/2 H.
 C. C17300 BERYLLIUM COPPER TD04
 1. INTERPRET DRAWING PER ASME-14.5M - 1994.
- NOTES: UNLESS OTHERWISE SPECIFIED.

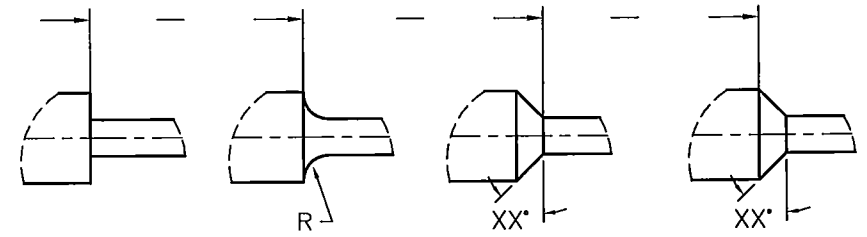

DETAIL "H1" DETAIL "H2" DETAIL "H3" DETAIL "H4"

**Aerospace
Contacts LLC**

THIS DOCUMENT IS ISSUED IN STRICT CONFIDENCE ON THE CONDITION THAT IT IS NOT TO BE USED AS THE BASIS FOR MANUFACTURING OR SALE, AND THAT IT IS NOT TO BE COPIED, REPRINTED OR DISCLOSED TO A THIRD PARTY EITHER WHOLLY OR IN PART WITHOUT THE WRITTEN CONSENT OF AEROSPACE CONTACTS, LLC.

REFERENCE: MIL-C-39029/58-364

MATING CONTACT: MIL-C-39029/

TYPE: CONTACT

DRAWN	SZL	
CHECKED		
APPROVED		

DIMENSIONS ARE IN INCHES
 TOLERANCES:
 DECIMALS: ANGLES:
 .XX = ±.005 ±1°
 .XXX = ±.003

**CONTACT #16 MASTER
PIN/PC**

CAGE:	1	SHEET OF 1	PART NUMBER	ACLCC
-------	---	------------	-------------	-------